

LED Strip COB Easy Set 24V RGBW

INSTALLATION MANUAL



⚠ Safety Notes:

- The product must be installed, maintained, and operated as instructions below.
- Before starting installation of this product, make sure power supply is disconnected.
- Only to be installed by authorized electrician.
- Do not use abrasives or solvents when cleaning.
- Do not install the product if it appears damaged in any way. Check with manufacturer if in doubt.
- Do not modify this fitting in any matter as this will void warranty.
- Check protection class, if class I, it must be earthed.
- Disconnect power supply before maintenance or cleaning.

⚠ Sikkerhetsinformasjon:

- Følg installasjonsmanual for korrekt montering.
- Koble alltid fra strømmen før montering eller vedlikehold.
- Kan kun monteres av autorisert elektriker.
- Monter ikke produktet hvis det er synlig skade. Kontakt forhandler eller produsent.
- Bruk ikke løsemidler ved rengjøring
- Produktet skal ikke under noen omstendigheter endres eller modifiseres.
- Sjekk produktets isolasjonsklasse. Ved isolasjonsklasse I skal produktet jordes.

1. Diagram of Easy Set components

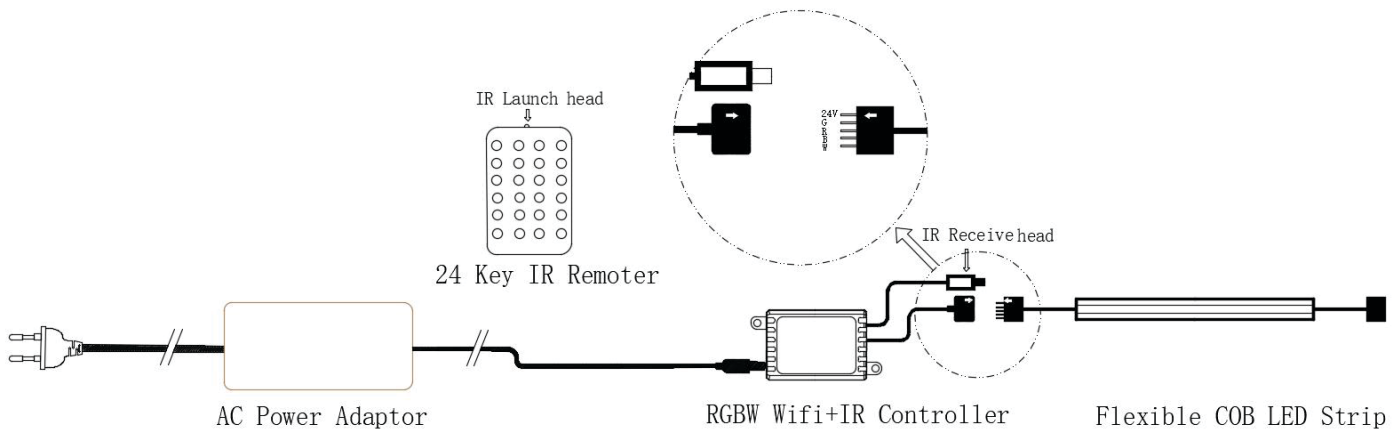

2. Operation Instructions

2.1 Open the package and check to see if any parts are broken. If in good condition, connect the power supply, light strip and controller according to the picture above. Note that the arrow position needs to be aligned when the controller is connected to the strip (as shown in the large circle in the picture above)

2.2 Plug the power adaptor input plug into the power supply socket , the light strip will light up, you can use the IR remote control light strip to adjust the brightness and color (note that the remoter launch head needs to be facing the rgbw controller receiver head, the middle can not be blocked, remote control distance 3-5 meters), The function of the remote control button is illustrated as follows picture

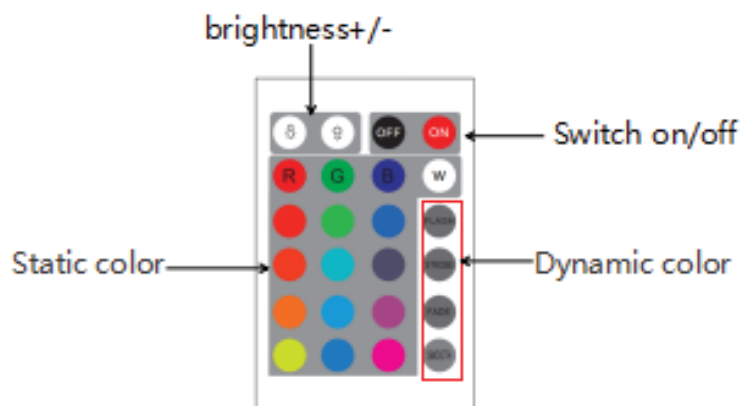

2.3 You can also use the Tuya app on your phone instead of the infrared remote to control the LED strip, which requires a WIFI network, Here are the steps:

2.3.1 Download App :

Search and download "Tuya Smart" in major application markets or scan the QR code below to download the App.



2.3.2 Registration/Login/Password Retrieval:

Registration

If you do not have an app account, you may choose to register or log in by authentication code. The registration process is described on this page and the next.

1. Click "Register" to go to the Smart Life privacy policy page. Click "Agree" to proceed to the registration page.

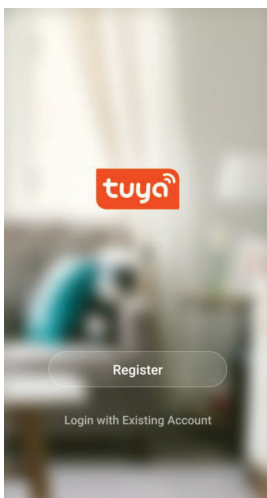

Fig.1

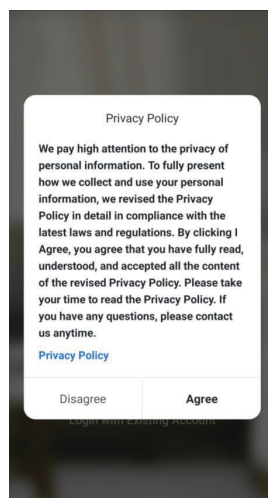

Fig.2

2. The system will identify automatically the country/region you are in, or you may choose to select manually a country/region. Enter your mobile phone number or email and click "Get authentication code", as shown in Fig. 3.

3. Enter the authentication code you received. Then enter the password and click "Completed" to complete registration.

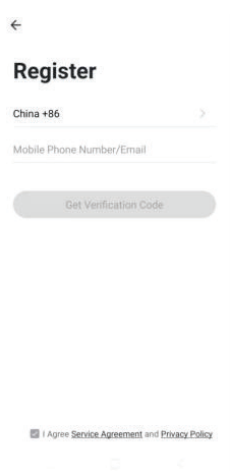

Fig.3

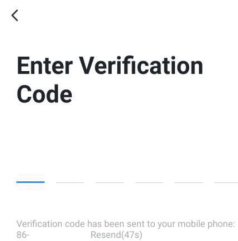

Fig.4

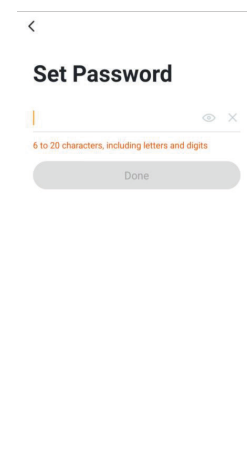
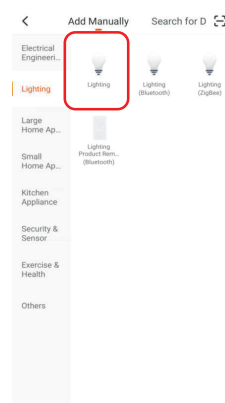
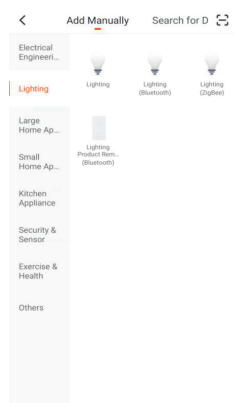
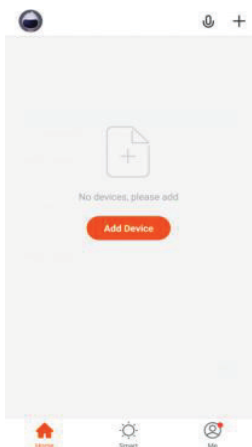

Fig.5

2.3.3 Add Devices:

Click "Add Device" or "+" at the top right corner of the App homepage to enter the "Add Device" page.



Add Manually -wifi device - default mode

1. The app supports two configurations: Default mode and AP mode. Click "AP Mode" at the top right corner of the "Default mode" page to switch between modes

2. To select "Default mode", please make sure the indicator light on the smart device is flashing rapidly (blinking twice per second) and then click the button to proceed to the next step

3. If the indicator light is not flashing rapidly, click "Help" to view the instructions

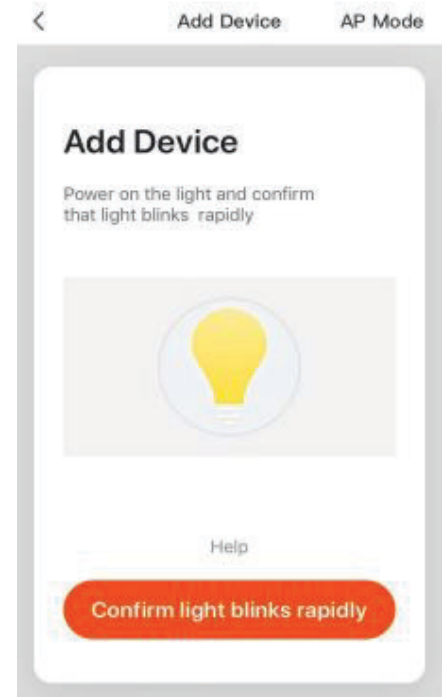

Notes: How to set indicator light to rapid flashing:



Add Manually -wifi device - Enter wifi password

In a selected mode, clicking confirm button on the page when the indicator light flashes rapidly/slowly will bring up the page shown in Fig. 6.

Select the Wi-Fi in the work area of a device that can enable successful Internet connection, enter the Wi-Fi password, and click "OK" to proceed to configuration.

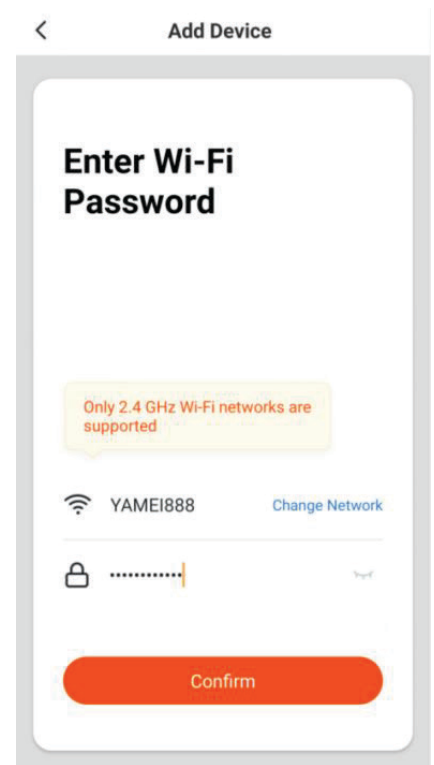
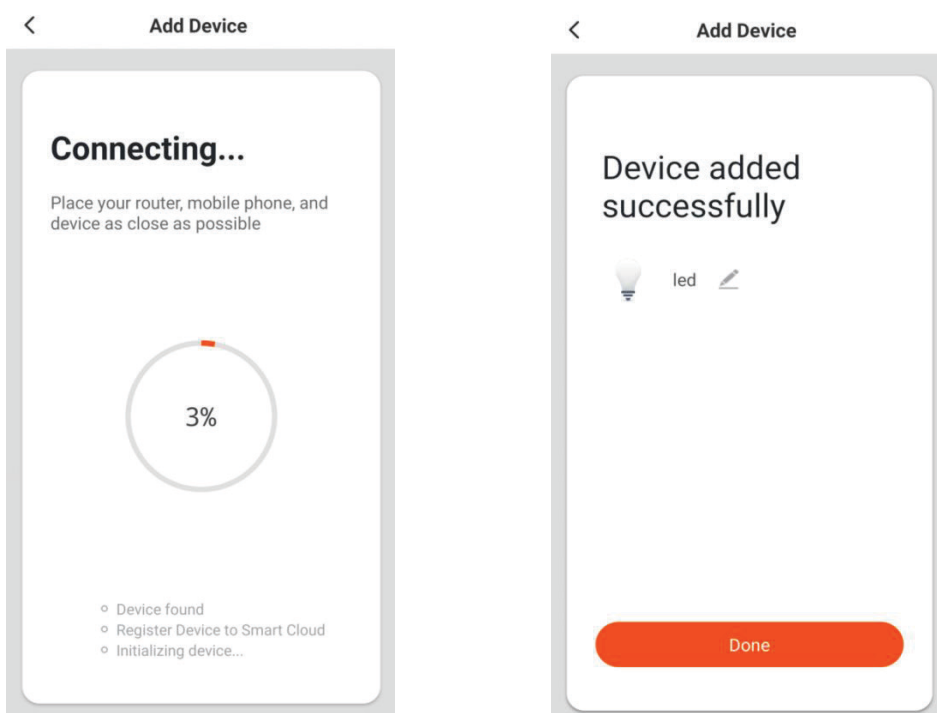
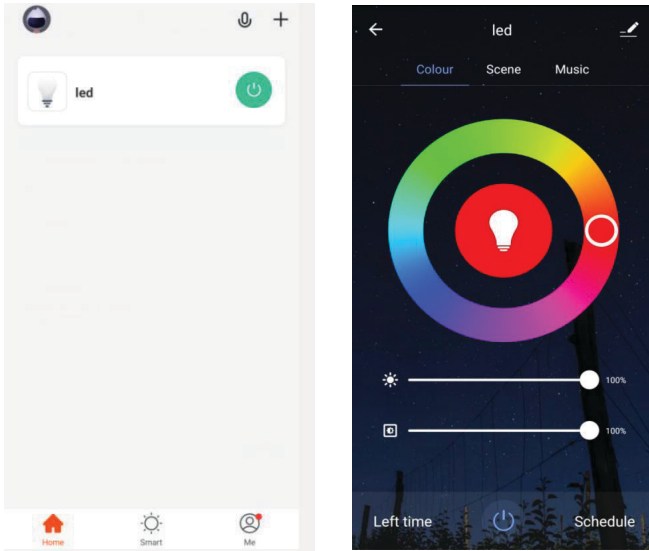

Fig. 6.

Add Manually– wifi device-Configuration



Control Devices - Individual Control:

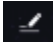

When devices have been configured successfully, the smart devices will appear on the home page. Click to open the control panel for smart devices.

Click " " at the top right corner of the control panel to manage individual devices.

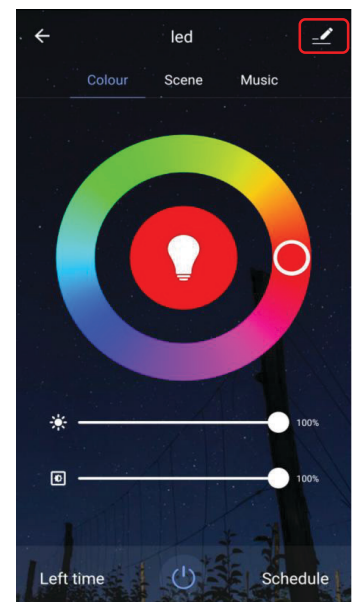

The device modification menu is shown in the figure:

1. Device Name: You can change the name and location of a device.

2. Device Location: You can choose where the device is located such as the living room or bedroom.

3. Share Device: You can share any individual device with others by entering their mobile phone numbers. (Note: Their mobile phone numbers must be registered with Tuya app accounts.)

4. Create Group: Click and the page will automatically show all devices that have been added and have the same model number. A group cannot be created for devices with different model numbers.

5. Device Information: Check here for: device ID, Wi-Fi signal strength, IP address, Mac address, and device time zone.

6. Feedback: You can submit feedback here on problems encountered during usage.

7. Add to Home Screen: You can add devices to your phone's desktop for easier control of your device.

8. Check for Firmware Update: You can check here for firmware updates.

9. Remove Device: Delete a previously added device from the list of devices.

10. Restore factory defaults: Remove devices and clear all data

